

Viewing Information

This photograph and visualisation is a cylindrical projection panorama. Hold this sheet at a comfortable arm's length from your eyes and curve the image through 90° and turn head to view. Alternatively, the visualisation can be laid flat and viewed by scanning left or right parallel to the sheet maintaining a 50cm viewing distance between your eye and the page.

This visualisation is a tool for assessment and is best used for comparison in the field from the viewpoint location shown. It cannot be considered a substitute for visiting the viewpoint location.

Technical Information

The technical photography, accuracy of 3D modelling and generation of visualisation is an Accurate Visual Representation. This is explained and presented in the accompanying Technical Methodology. **Printing Note**

This viewpoint visualisation is spread across a single sheet 841mm wide and 297mm high. To give the correct viewing distance the sheet should be printed at a scale of 1:1 on large format paper and cut to size. Do not print at A3



North West Cambridge
Viewpoint 17

Illustrative Masterplan with Year 15 Landscaping 3D Model View

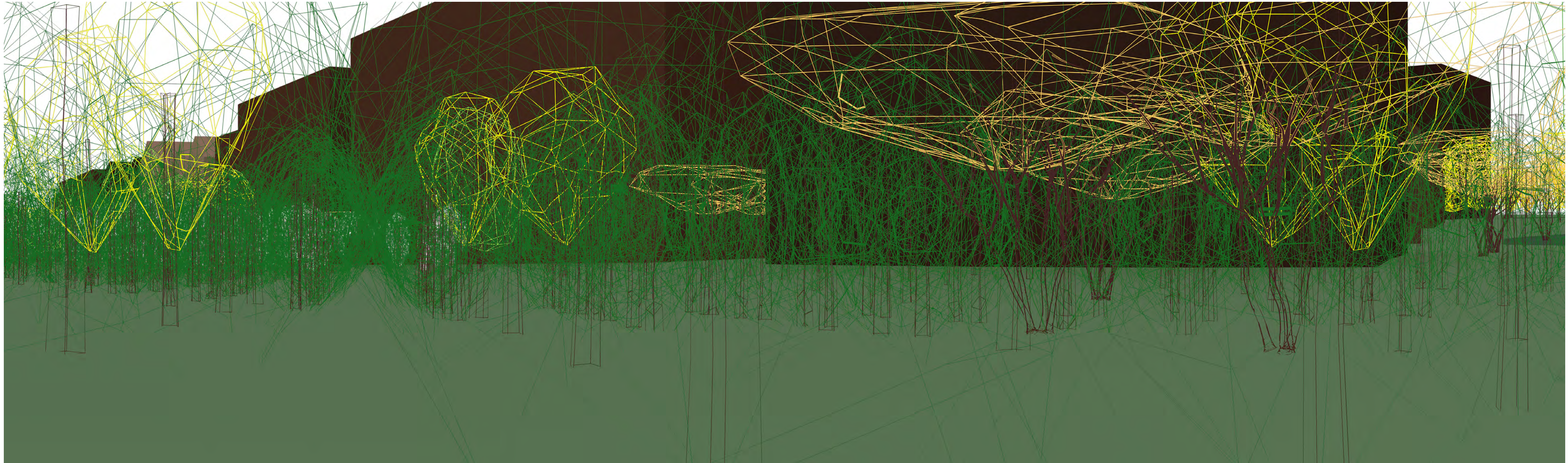

Viewing Information

This photograph and visualisation is a cylindrical projection panorama. Hold this sheet at a comfortable arm's length from your eyes and curve the image through 90° and turn head to view. Alternatively, the visualisation can be laid flat and viewed by scanning left or right parallel to the sheet maintaining a 50cm viewing distance between your eye and the page.

This visualisation is a tool for assessment and is best used for comparison in the field from the viewpoint location shown. It cannot be considered a substitute for visiting the viewpoint location.

Technical Information

The technical photography, accuracy of 3D modelling and generation of visualisation is an Accurate Visual Representation. This is explained and presented in the accompanying Technical Methodology. **Printing Note**

This viewpoint visualisation is spread across a single sheet 841mm wide and 297mm high. To give the correct viewing distance the sheet should be printed at a scale of 1:1 on large format paper and cut to size. Do not print at A3



North West Cambridge
Viewpoint 17

Illustrative Masterplan with Year 15 Landscaping 3D Model View

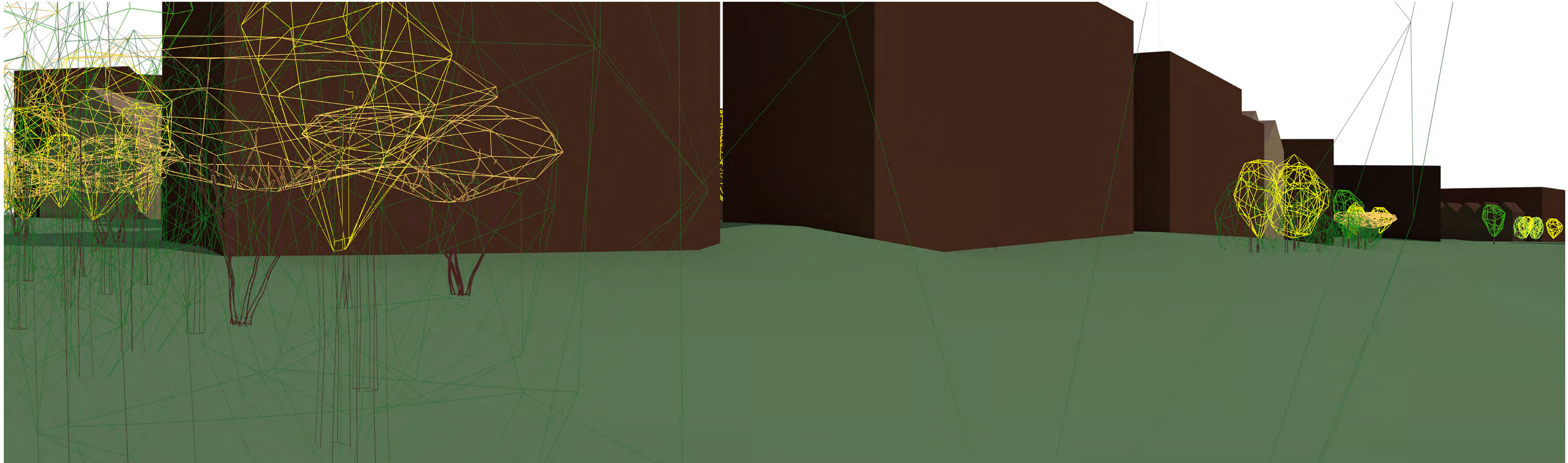

Viewing Information

This photograph and visualisation is a cylindrical projection panorama. Hold this sheet at a comfortable arm's length from your eyes and curve the image through 90° and turn head to view. Alternatively, the visualisation can be laid flat and viewed by scanning left or right parallel to the sheet maintaining a 50cm viewing distance between your eye and the page.

This visualisation is a tool for assessment and is best used for comparison in the field from the viewpoint location shown. It cannot be considered a substitute for visiting the viewpoint location.

Technical Information

The technical photography, accuracy of 3D modelling and generation of visualisation is an Accurate Visual Representation. This is explained and presented in the accompanying Technical Methodology.
Printing Note

This viewpoint visualisation is spread across a single sheet 841mm wide and 297mm high. To give the correct viewing distance the sheet should be printed at a scale of 1:1 on large format paper and cut to size. Do not print at A3



North West Cambridge
Viewpoint 17

Illustrative Masterplan with Year 15 Landscaping 3D Model View

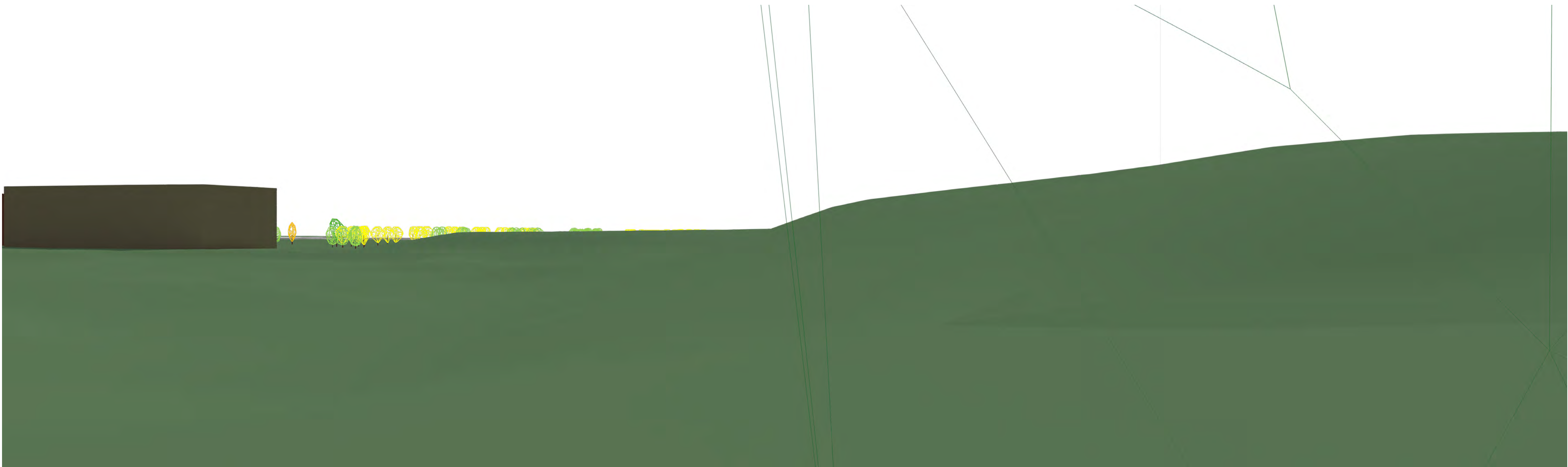

Viewing Information

This photograph and visualisation is a cylindrical projection panorama. Hold this sheet at a comfortable arm's length from your eyes and curve the image through 90° and turn head to view. Alternatively, the visualisation can be laid flat and viewed by scanning left or right parallel to the sheet maintaining a 50cm viewing distance between your eye and the page.

This visualisation is a tool for assessment and is best used for comparison in the field from the viewpoint location shown. It cannot be considered a substitute for visiting the viewpoint location.

Technical Information

The technical photography, accuracy of 3D modelling and generation of visualisation is an Accurate Visual Representation. This is explained and presented in the accompanying Technical Methodology.

Printing Note

This viewpoint visualisation is spread across a single sheet 841mm wide and 297mm high. To give the correct viewing distance the sheet should be printed at a scale of 1:1 on large format paper and cut to size. Do not print at A3



North West Cambridge

Viewpoint 17

Illustrative Masterplan with Year 15 Landscaping 3D Model View

Photography, 3D Model Images and Accurate Visual Representations (AVRs)

North West Cambridge

Year 15 Landscaping (Viewpoint 17 Part 2)

March 2026



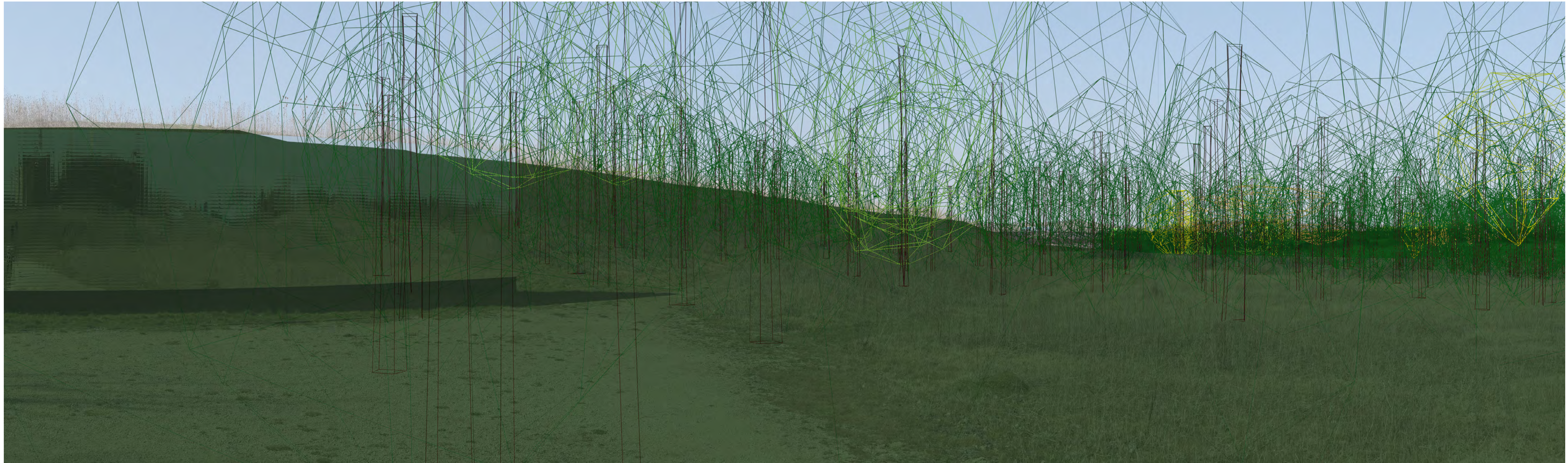

Viewing Information

This photograph and visualisation is a cylindrical projection panorama. Hold this sheet at a comfortable arm's length from your eyes and curve the image through 90° and turn head to view. Alternatively, the visualisation can be laid flat and viewed by scanning left or right parallel to the sheet maintaining a 50cm viewing distance between your eye and the page.

This visualisation is a tool for assessment and is best used for comparison in the field from the viewpoint location shown. It cannot be considered a substitute for visiting the viewpoint location.

Technical Information

The technical photography, accuracy of 3D modelling and generation of visualisation is an Accurate Visual Representation. This is explained and presented in the accompanying Technical Methodology. **Printing Note**

This viewpoint visualisation is spread across a single sheet 841mm wide and 297mm high. To give the correct viewing distance the sheet should be printed at a scale of 1:1 on large format paper and cut to size. Do not print at A3



North West Cambridge
Viewpoint 17

Illustrative Masterplan with Year 15 Landscaping 3D Model Composite View

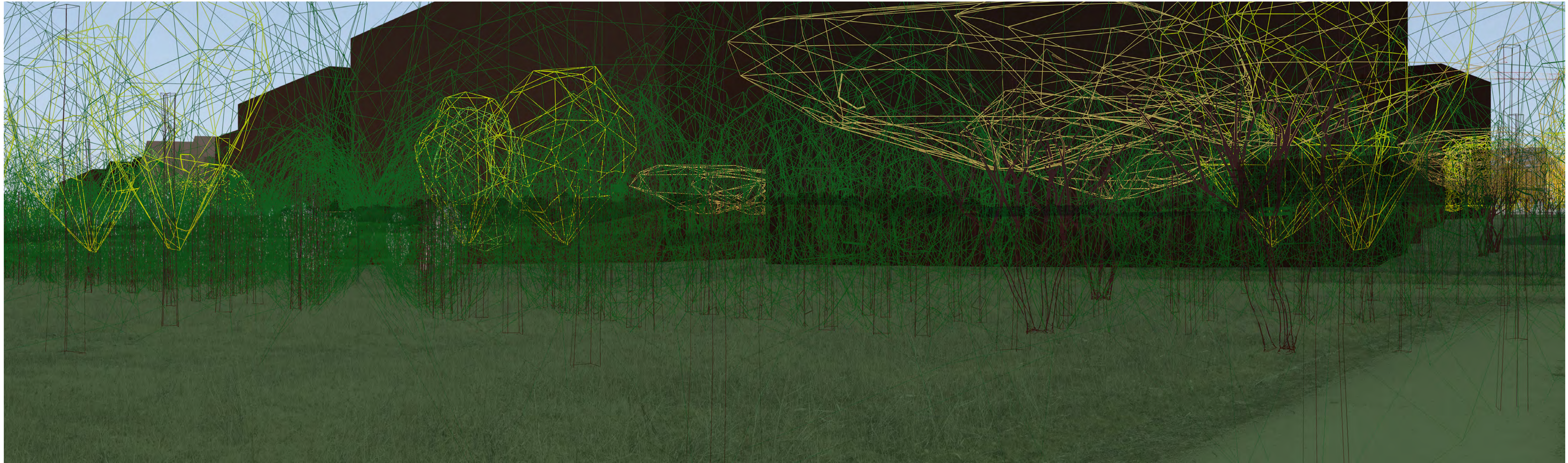

Viewing Information

This photograph and visualisation is a cylindrical projection panorama. Hold this sheet at a comfortable arm's length from your eyes and curve the image through 90° and turn head to view. Alternatively, the visualisation can be laid flat and viewed by scanning left or right parallel to the sheet maintaining a 50cm viewing distance between your eye and the page.

This visualisation is a tool for assessment and is best used for comparison in the field from the viewpoint location shown. It cannot be considered a substitute for visiting the viewpoint location.

Technical Information

The technical photography, accuracy of 3D modelling and generation of visualisation is an Accurate Visual Representation. This is explained and presented in the accompanying Technical Methodology. **Printing Note**

This viewpoint visualisation is spread across a single sheet 841mm wide and 297mm high. To give the correct viewing distance the sheet should be printed at a scale of 1:1 on large format paper and cut to size. Do not print at A3



North West Cambridge
Viewpoint 17

Illustrative Masterplan with Year 15 Landscaping 3D Model Composite View

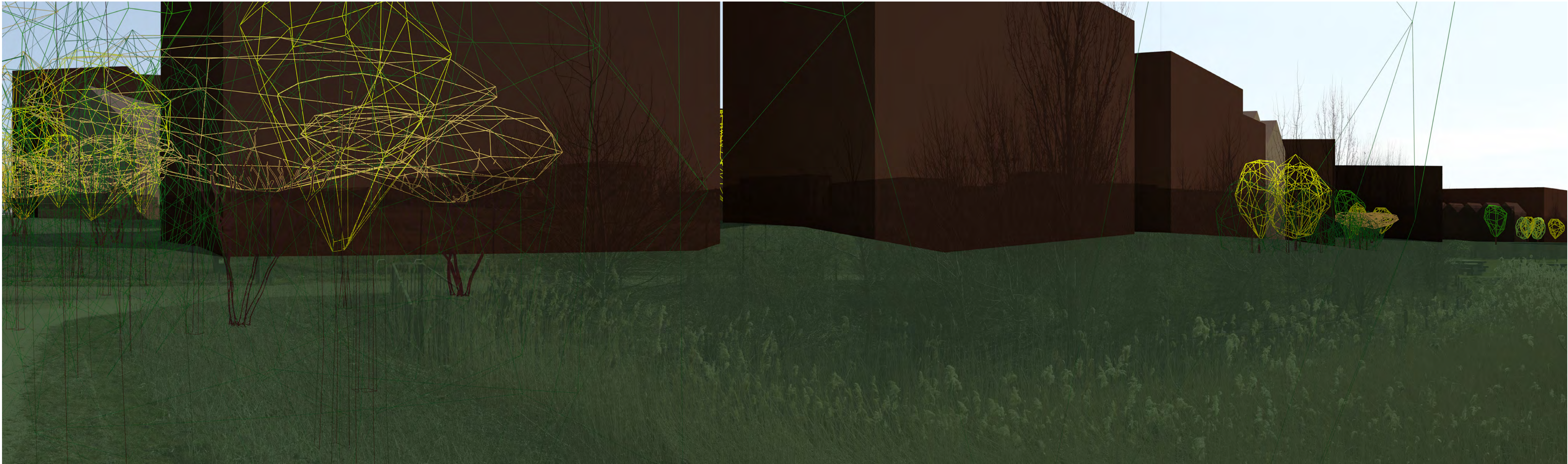

Viewing Information

This photograph and visualisation is a cylindrical projection panorama. Hold this sheet at a comfortable arm's length from your eyes and curve the image through 90° and turn head to view. Alternatively, the visualisation can be laid flat and viewed by scanning left or right parallel to the sheet maintaining a 50cm viewing distance between your eye and the page.

This visualisation is a tool for assessment and is best used for comparison in the field from the viewpoint location shown. It cannot be considered a substitute for visiting the viewpoint location.

Technical Information

The technical photography, accuracy of 3D modelling and generation of visualisation is an Accurate Visual Representation. This is explained and presented in the accompanying Technical Methodology. **Printing Note**

This viewpoint visualisation is spread across a single sheet 841mm wide and 297mm high. To give the correct viewing distance the sheet should be printed at a scale of 1:1 on large format paper and cut to size. Do not print at A3



North West Cambridge
Viewpoint 17

Illustrative Masterplan with Year 15 Landscaping 3D Model Composite View

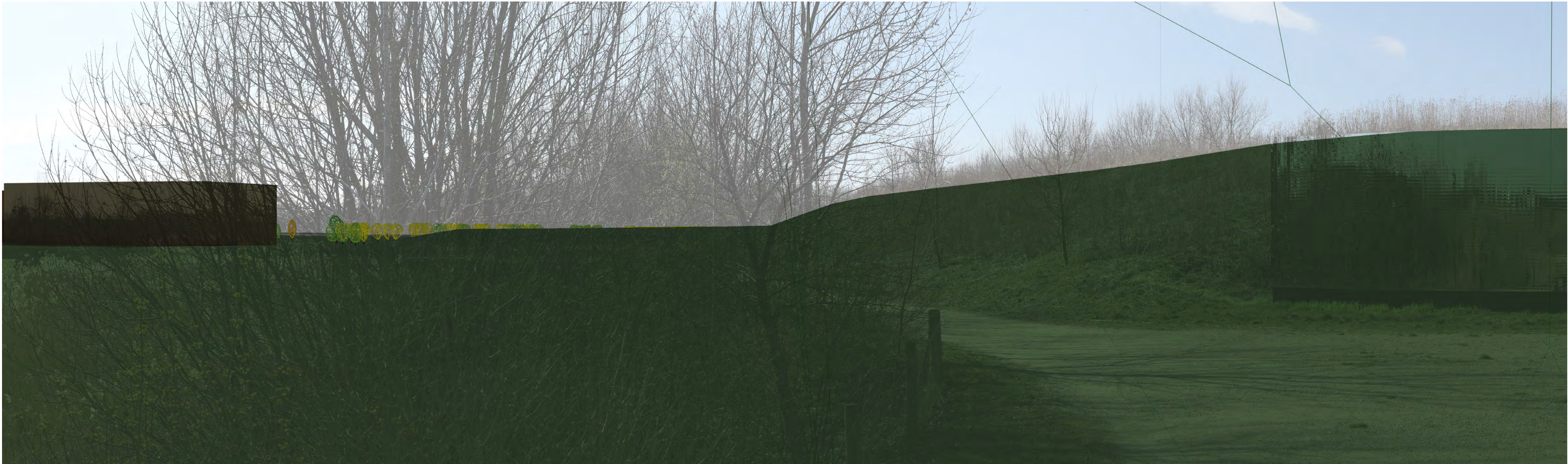

Viewing Information

This photograph and visualisation is a cylindrical projection panorama. Hold this sheet at a comfortable arm's length from your eyes and curve the image through 90° and turn head to view. Alternatively, the visualisation can be laid flat and viewed by scanning left or right parallel to the sheet maintaining a 50cm viewing distance between your eye and the page.

This visualisation is a tool for assessment and is best used for comparison in the field from the viewpoint location shown. It cannot be considered a substitute for visiting the viewpoint location.

Technical Information

The technical photography, accuracy of 3D modelling and generation of visualisation is an Accurate Visual Representation. This is explained and presented in the accompanying Technical Methodology.

Printing Note

This viewpoint visualisation is spread across a single sheet 841mm wide and 297mm high. To give the correct viewing distance the sheet should be printed at a scale of 1:1 on large format paper and cut to size. Do not print at A3



**North West Cambridge
Viewpoint 17**

Illustrative Masterplan with Year 15 Landscaping 3D Model Composite View

Photography, 3D Model Images and Accurate Visual Representations (AVRs)

North West Cambridge

Year 15 Landscaping (Viewpoint 30)

March 2026





Viewing Information

This photograph and visualisation is a cylindrical projection panorama. Hold this sheet at a comfortable arm's length from your eyes and curve the image through 90° and turn head to view. Alternatively, the visualisation can be laid flat and viewed by scanning left or right parallel to the sheet maintaining a 50cm viewing distance between your eye and the page.

This visualisation is a tool for assessment and is best used for comparison in the field from the viewpoint location shown. It cannot be considered a substitute for visiting the viewpoint location.

Technical Information

The technical photography, accuracy of 3D modelling and generation of visualisation is an Accurate Visual Representation. This is explained and presented in the accompanying Technical Methodology.

Printing Note

This viewpoint visualisation is spread across a single sheet 841mm wide and 297mm high. To give the correct viewing distance the sheet should be printed at a scale of 1:1 on large format paper and cut to size. Do not print at A3



North West Cambridge
Viewpoint 30
Existing (Winter) View



Viewing Information

This photograph and visualisation is a cylindrical projection panorama. Hold this sheet at a comfortable arm's length from your eyes and curve the image through 90° and turn head to view. Alternatively, the visualisation can be laid flat and viewed by scanning left or right parallel to the sheet maintaining a 50cm viewing distance between your eye and the page.

This visualisation is a tool for assessment and is best used for comparison in the field from the viewpoint location shown. It cannot be considered a substitute for visiting the viewpoint location.

Technical Information

The technical photography, accuracy of 3D modelling and generation of visualisation is an Accurate Visual Representation. This is explained and presented in the accompanying Technical Methodology.

Printing Note

This viewpoint visualisation is spread across a single sheet 841mm wide and 297mm high. To give the correct viewing distance the sheet should be printed at a scale of 1:1 on large format paper and cut to size. Do not print at A3



North West Cambridge
Viewpoint 30

Illustrative Masterplan with Year 15 Landscaping 3D Model View

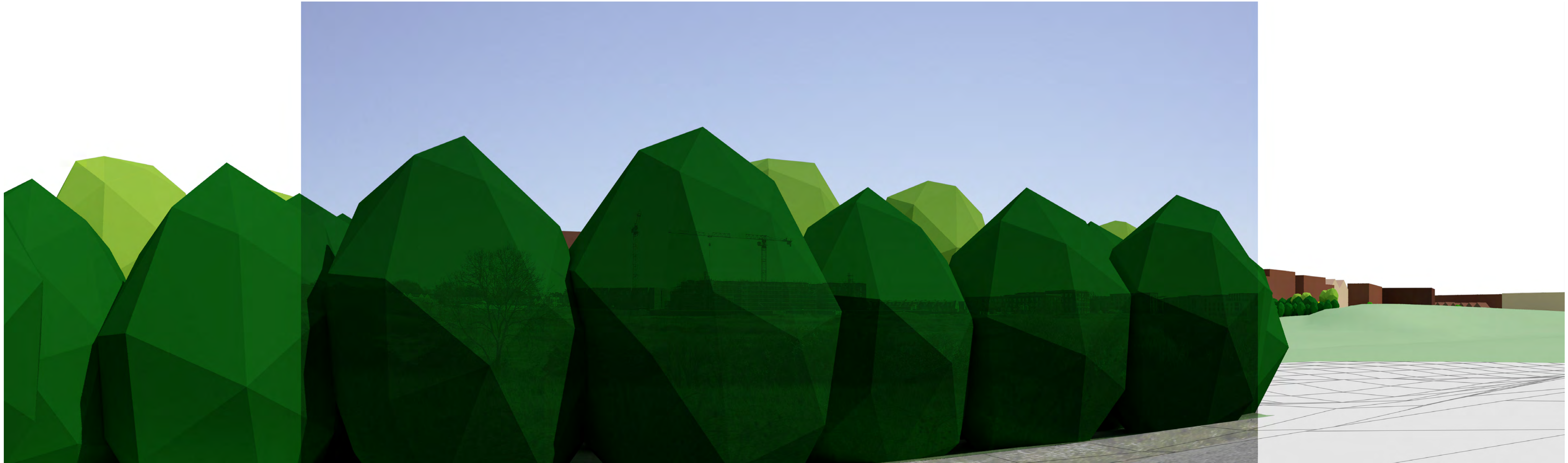

Viewing Information

This photograph and visualisation is a cylindrical projection panorama. Hold this sheet at a comfortable arm's length from your eyes and curve the image through 90° and turn head to view. Alternatively, the visualisation can be laid flat and viewed by scanning left or right parallel to the sheet maintaining a 50cm viewing distance between your eye and the page.

This visualisation is a tool for assessment and is best used for comparison in the field from the viewpoint location shown. It cannot be considered a substitute for visiting the viewpoint location.

Technical Information

The technical photography, accuracy of 3D modelling and generation of visualisation is an Accurate Visual Representation. This is explained and presented in the accompanying Technical Methodology. **Printing Note**

This viewpoint visualisation is spread across a single sheet 841mm wide and 297mm high. To give the correct viewing distance the sheet should be printed at a scale of 1:1 on large format paper and cut to size. Do not print at A3



North West Cambridge
Viewpoint 30

Illustrative Masterplan with Year 15 Landscaping 3D Model Composite View

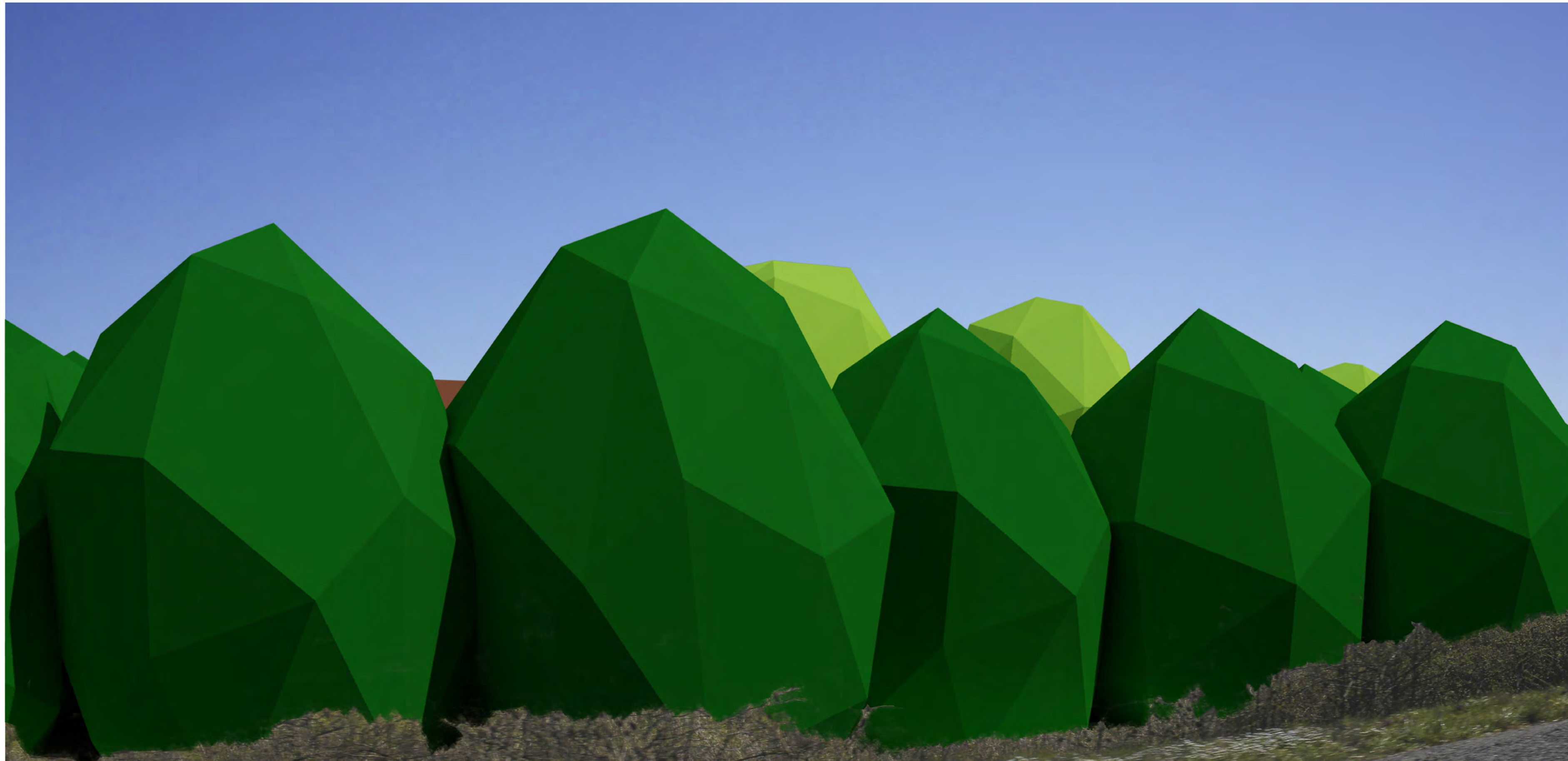

Viewing Information

This photograph and visualisation is a cylindrical projection panorama. Hold this sheet at a comfortable arm's length from your eyes and curve the image through 90° and turn head to view. Alternatively, the visualisation can be laid flat and viewed by scanning left or right parallel to the sheet maintaining a 50cm viewing distance between your eye and the page.

This visualisation is a tool for assessment and is best used for comparison in the field from the viewpoint location shown. It cannot be considered a substitute for visiting the viewpoint location.

Technical Information

The technical photography, accuracy of 3D modelling and generation of visualisation is an Accurate Visual Representation. This is explained and presented in the accompanying Technical Methodology. **Printing Note**

This viewpoint visualisation is spread across a single sheet 841mm wide and 297mm high. To give the correct viewing distance the sheet should be printed at a scale of 1:1 on large format paper and cut to size. Do not print at A3



North West Cambridge
Viewpoint 30

Illustrative Masterplan with Year 15 Landscaping Photomontage View (AVR2)

Photography, 3D Model Images and Accurate Visual Representations (AVRs)

North West Cambridge

Year 15 Landscaping (Viewpoint 31)

March 2026





Viewing Information

This photograph and visualisation is a cylindrical projection panorama. Hold this sheet at a comfortable arm's length from your eyes and curve the image through 90° and turn head to view. Alternatively, the visualisation can be laid flat and viewed by scanning left or right parallel to the sheet maintaining a 50cm viewing distance between your eye and the page.

This visualisation is a tool for assessment and is best used for comparison in the field from the viewpoint location shown. It cannot be considered a substitute for visiting the viewpoint location.

Technical Information

The technical photography, accuracy of 3D modelling and generation of visualisation is an Accurate Visual Representation. This is explained and presented in the accompanying Technical Methodology.

Printing Note

This viewpoint visualisation is spread across a single sheet 841mm wide and 297mm high. To give the correct viewing distance the sheet should be printed at a scale of 1:1 on large format paper and cut to size. Do not print at A3



North West Cambridge
Viewpoint 31
Existing (Winter) View