



Viewing Information

This photograph and visualisation is a cylindrical projection panorama. Hold this sheet at a comfortable arm's length from your eyes and curve the image through 90° and turn head to view. Alternatively, the visualisation can be laid flat and viewed by scanning left or right parallel to the sheet maintaining a 50cm viewing distance between your eye and the page.

This visualisation is a tool for assessment and is best used for comparison in the field from the viewpoint location shown. It cannot be considered a substitute for visiting the viewpoint location.

Technical Information

The technical photography, accuracy of 3D modelling and generation of visualisation is an Accurate Visual Representation. This is explained and presented in the accompanying Technical Methodology. **Printing Note**

This viewpoint visualisation is spread across a single sheet 841mm wide and 297mm high. To give the correct viewing distance the sheet should be printed at a scale of 1:1 on large format paper and cut to size. Do not print at A3



North West Cambridge
Viewpoint 33a

Illustrative Masterplan Photomontage View (AVR2)



Viewing Information

This photograph and visualisation is a cylindrical projection panorama. Hold this sheet at a comfortable arm's length from your eyes and curve the image through 90° and turn head to view. Alternatively, the visualisation can be laid flat and viewed by scanning left or right parallel to the sheet maintaining a 50cm viewing distance between your eye and the page.

This visualisation is a tool for assessment and is best used for comparison in the field from the viewpoint location shown. It cannot be considered a substitute for visiting the viewpoint location.

Technical Information

The technical photography, accuracy of 3D modelling and generation of visualisation is an Accurate Visual Representation. This is explained and presented in the accompanying Technical Methodology.

Printing Note

This viewpoint visualisation is spread across a single sheet 841mm wide and 297mm high. To give the correct viewing distance the sheet should be printed at a scale of 1:1 on large format paper and cut to size. Do not print at A3



North West Cambridge
Viewpoint 33a

Illustrative Masterplan Photomontage View (AVR2)

APPENDIX 2

TYPE 2 – VUCITY TECHNICAL VISUALISATIONS

NWC Masterplan LVIA Testing

View Plan

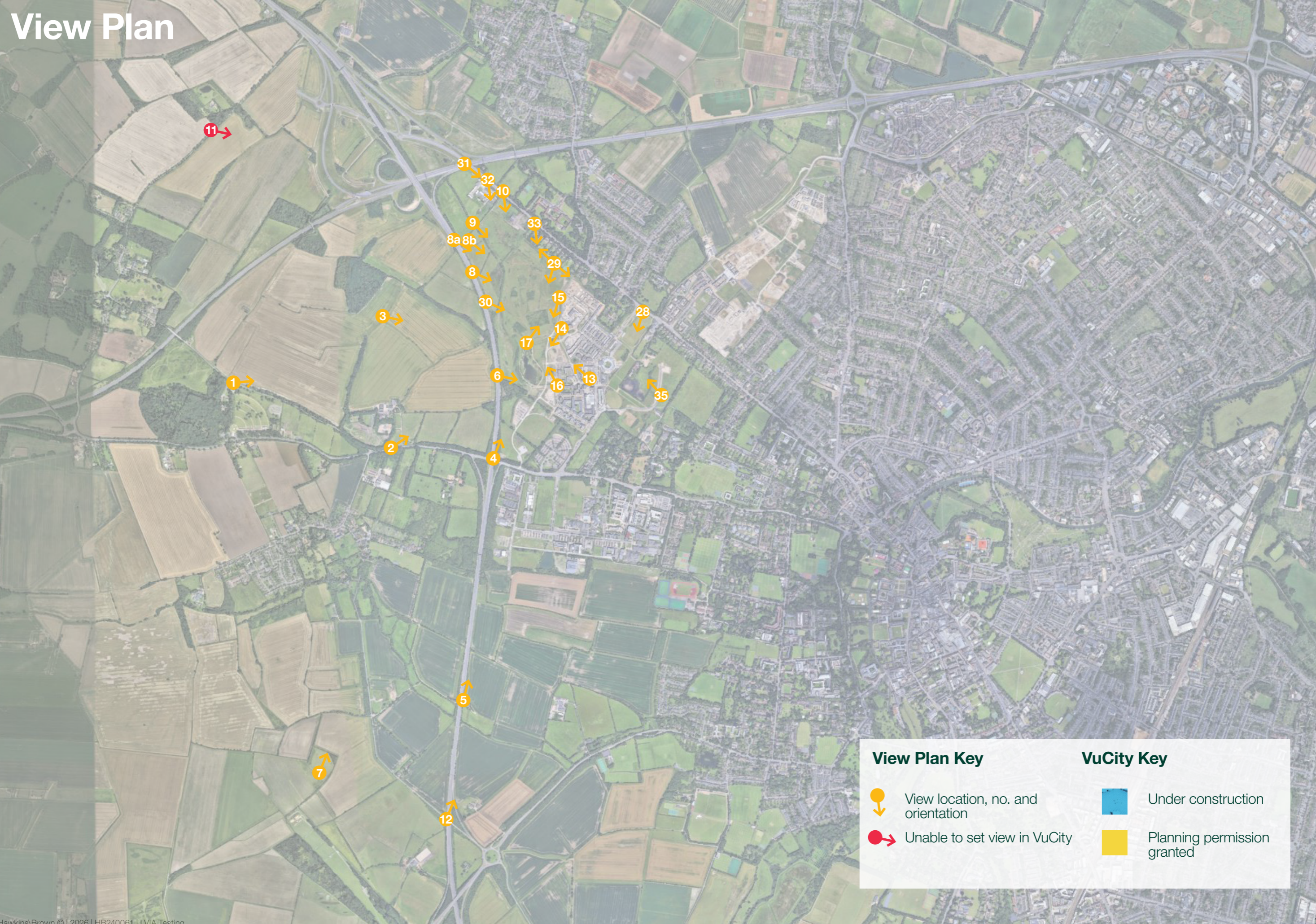

View Plan Key

- View location, no. and orientation
- Unable to set view in VuCity

VuCity Key

- Under construction
- Planning permission granted

View 1



View 1 - Current condition



Camera Location [540374, 36, 259843] Bearing 72° Pitch 0° Focal Length 24mm 21/06/2024 16:00

© VU.CITY 20

View 1 - 2026 Max parameters



Camera Location [540374, 36, 259843] Bearing 72° Pitch 0° Focal Length 24mm 21/06/2024 16:00

© VU.CITY 20

View 1 - Illustrative Scheme

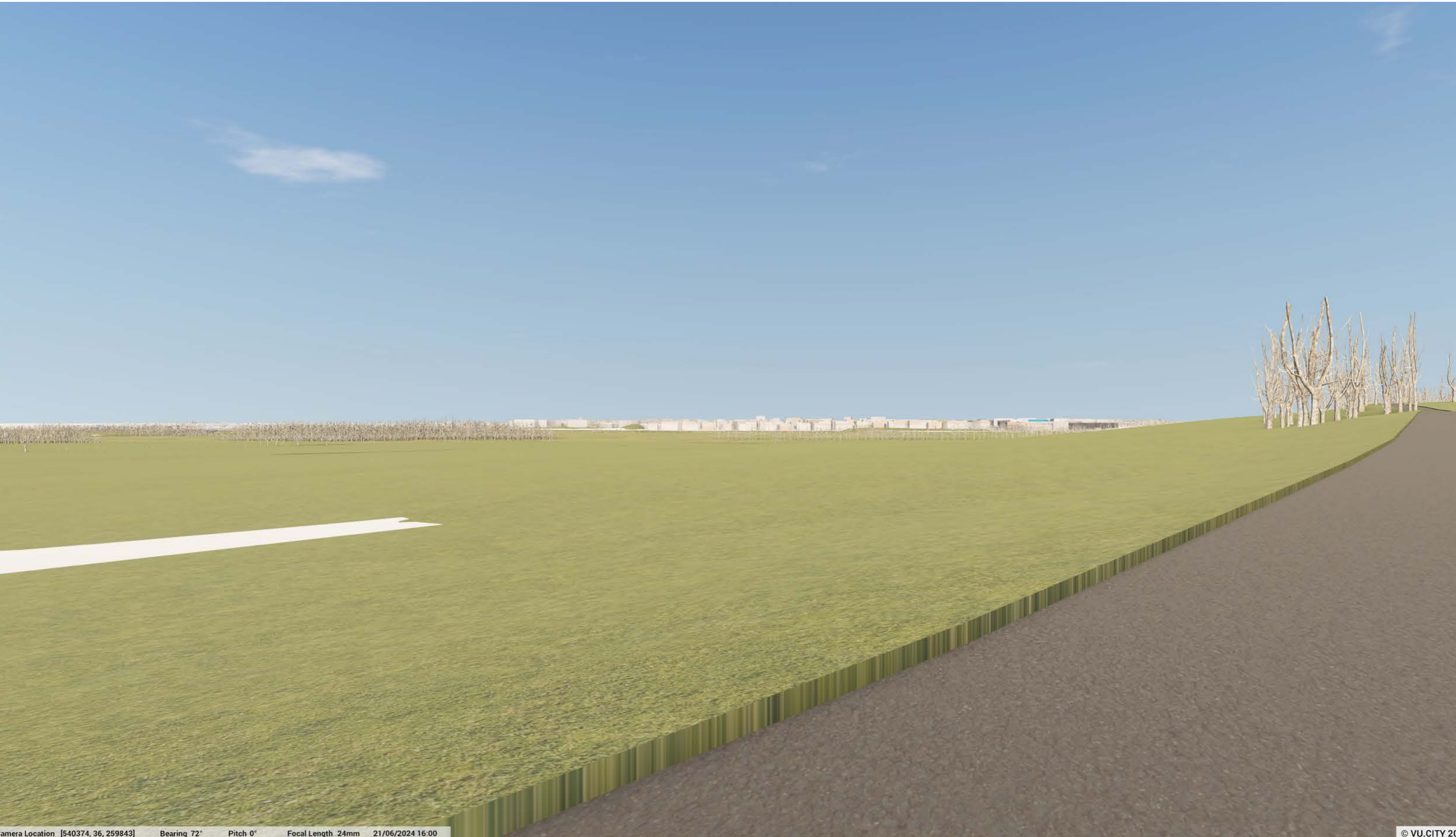

Camera Location [540374, 36, 259843] Bearing 72° Pitch 0° Focal Length 24mm 21/06/2024 16:00

© VU.CITY 20

View 1 overview

Photograph



Illustrative scheme

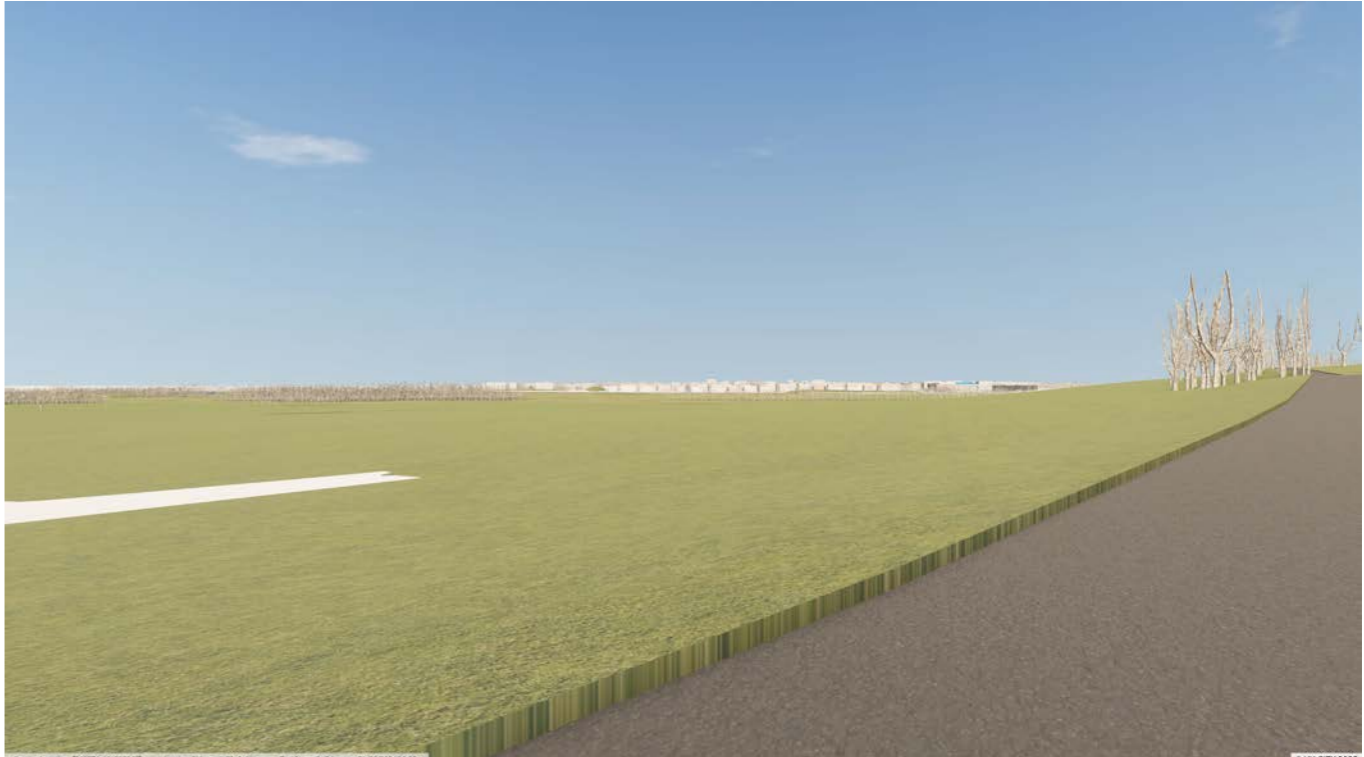

2025 Max Parameters

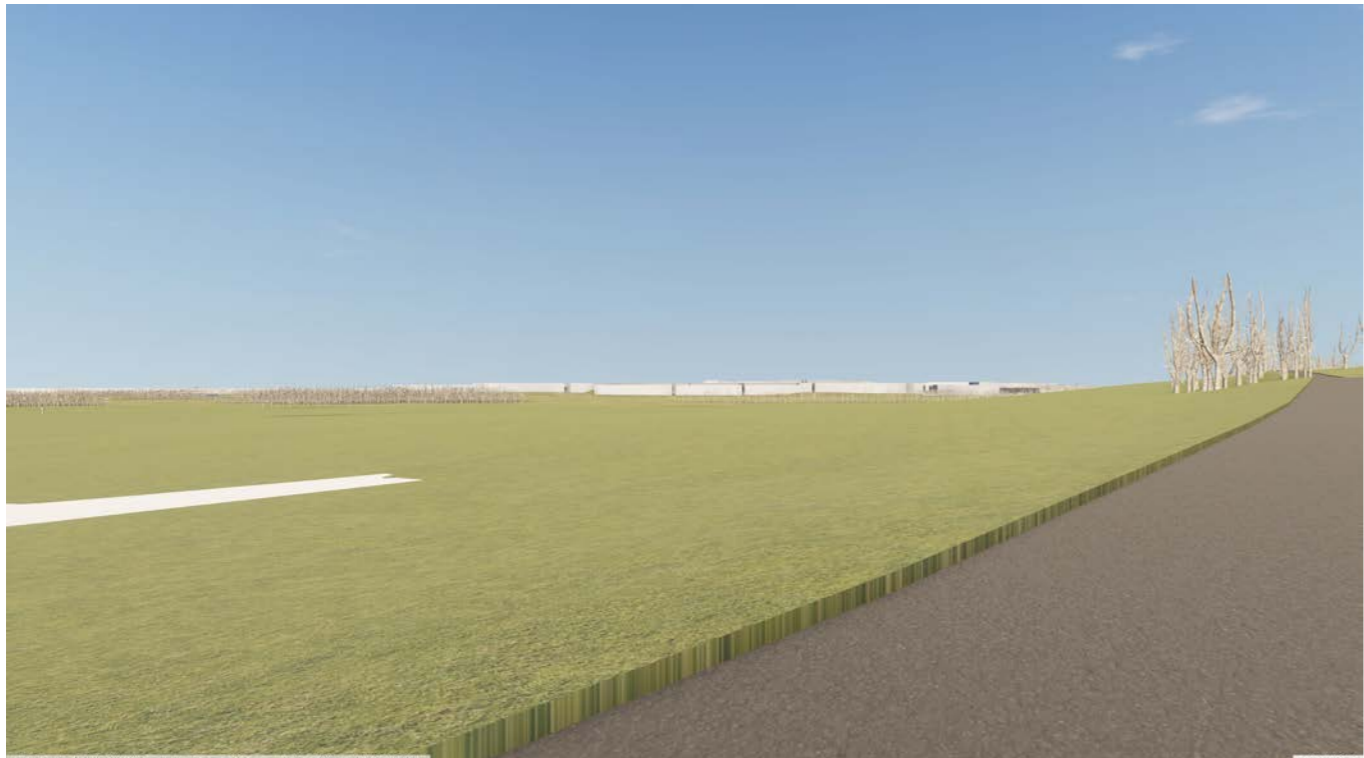

2026 Max Parameters

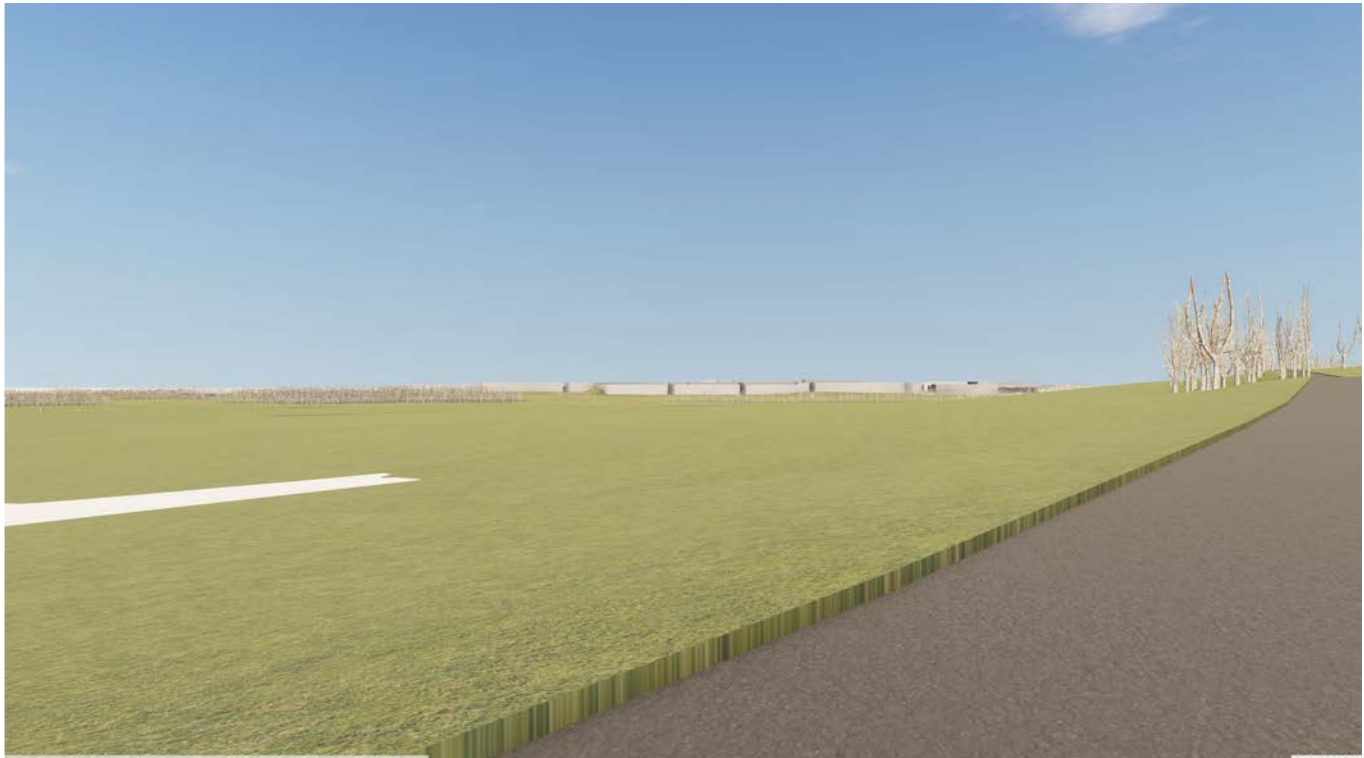

View 2



View 2 - Current condition



Camera Location [541415, 29, 259429] Bearing 42° Pitch 1° Focal Length 24mm 21/06/2024 16:00

© VU.CITY 20

View 2 - 2026 Max parameters



Camera Location [541415, 29, 259429] Bearing 42° Pitch 1° Focal Length 24mm 21/06/2024 16:00

© VU.CITY 20

View 2 - Illustrative Scheme



Camera Location [541415, 29, 259429] Bearing 42° Pitch 1° Focal Length 24mm 21/06/2024 16:00

© VU.CITY 20

View 2 overview

Photograph



Illustrative scheme



2025 Max Parameters



2026 Max Parameters



View 3



View 3 - Current condition



Camera Location [541350, 17, 260264] Bearing 98° Pitch 1° Focal Length 24mm 21/06/2024 16:00

© VU.CITY 20

View 3 - 2026 Max Parameters



Camera Location [541350, 17, 260264] Bearing 98° Pitch 1° Focal Length 24mm 21/06/2024 16:00

© VU.CITY 20

View 3 - Illustrative scheme



Camera Location [541350, 17, 260264] Bearing 98° Pitch 1° Focal Length 24mm 21/06/2024 16:00

© VU.CITY 20

View 3 overview

Photograph



Illustrative scheme



2025 Max Parameters



2026 Max Parameters



View 4



View 4 - Current condition



Camera Location [542085, 24, 259391] Bearing 21° Pitch 1° Focal Length 24mm 21/06/2024 16:00

© VU.CITY 20

View 4 - 2026 Max Parameters



Camera Location [542085, 24, 259391] Bearing 21° Pitch 1° Focal Length 24mm 21/06/2024 16:00

© VU.CITY 20

View 4 - Illustrative scheme



Camera Location [542085, 24, 259391] Bearing 21° Pitch 1° Focal Length 24mm 21/06/2024 16:00

© VU.CITY 20

View 4 overview

Photograph



Illustrative scheme



2025 Max Parameters



2026 Max Parameters



View 5



View 5 - Current condition



Camera Location [541905, 23, 257810] Bearing 31° Pitch -2° Focal Length 24mm 21/06/2024 16:00

© VU.CITY 20

View 5 - 2026 Max Parameters



Camera Location [541905, 23, 257810] Bearing 31° Pitch -2° Focal Length 24mm 21/06/2024 16:00

© VU.CITY 20

View 5 - Illustrative scheme



Camera Location [541905, 23, 257810] Bearing 31° Pitch -2° Focal Length 24mm 21/06/2024 16:00

© VU.CITY 20

View 5 overview

Photograph



Illustrative scheme



2025 Max Parameters



2026 Max Parameters



View 6



View 6 - Current condition



Camera Location [542111, 16, 259914] Bearing 64° Pitch 2° Focal Length 24mm 21/06/2024 16:00

© VU.CITY 20

View 6 - 2026 Max Parameters



Camera Location [542111, 16, 259914] Bearing 64° Pitch 2° Focal Length 24mm 21/06/2024 16:00

© VU.CITY 20

View 6 - Illustrative scheme



Camera Location [542111, 16, 259914] Bearing 64° Pitch 2° Focal Length 24mm 21/06/2024 16:00

© VU.CITY 20