









- NOTES:**
- (C) This drawing is copyright.
 - All dimensions to be checked on site.
 - Do not scale from this drawing; only figured dimensions are to be worked from.
 - Any discrepancies must be reported immediately before proceeding.
 - This drawing to be read & printed in colour.
 - This drawing is based on Grant Associates Proposed Tree Planting Strategy drawing No. NEP18-GRA-SK-76 Rev 05 dated 17/04/2025.
 - This drawing is based on Hawkins Brown Gateway 3 Masterplan_Illustrative Plan drawing No. NWC-MP2024-HBA-SW-DR-0130 Rev P02 dated 11/03/2025.

- KEY**
-  Carriageway
 -  Overrun area
 -  Footway
 -  Cycleway
 -  Verge
 -  Site boundary
 -  Highway boundary
 -  Highway boundary (National Highways)



Key Plan Scale 1:5000

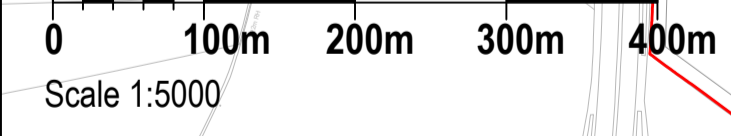
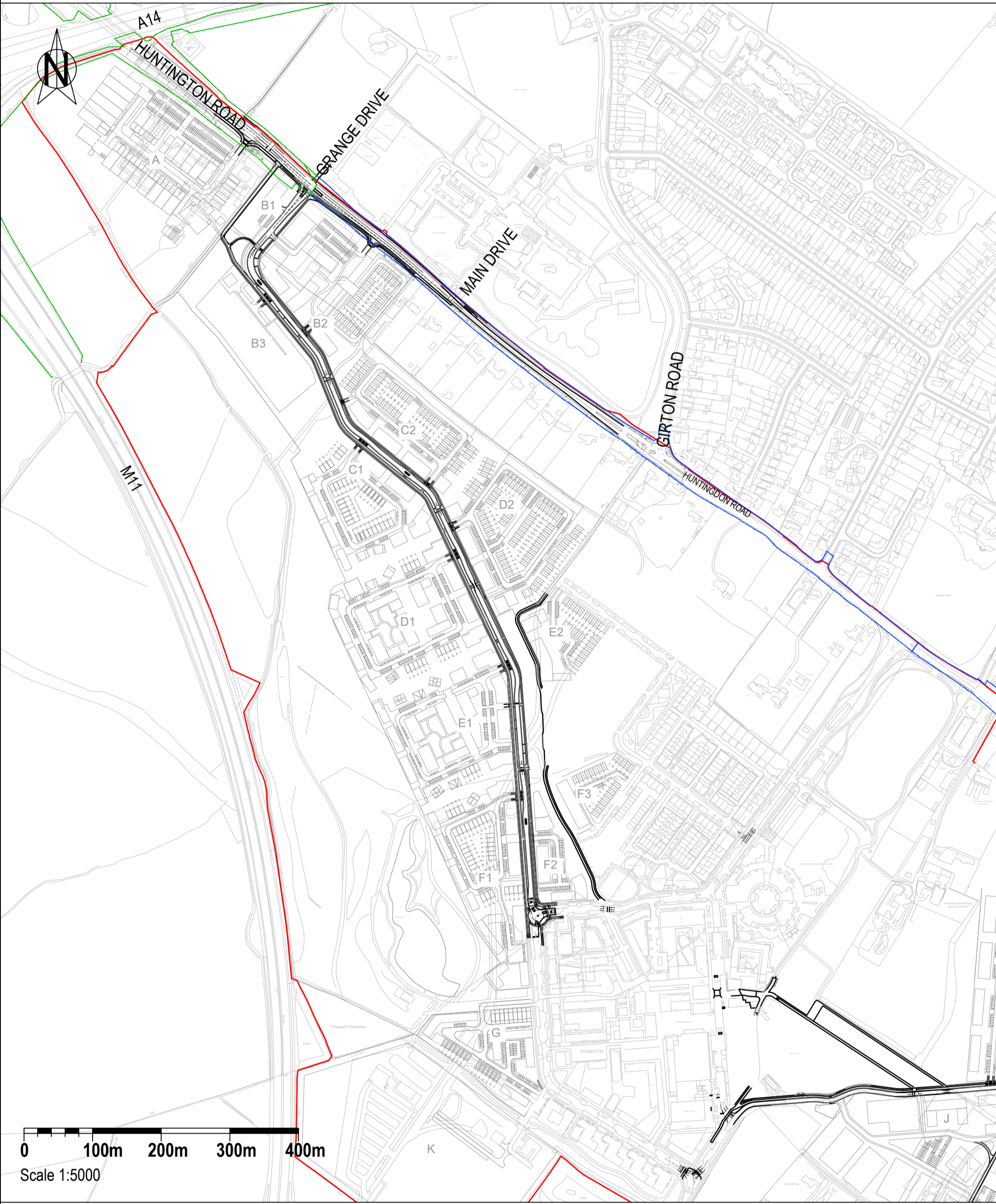
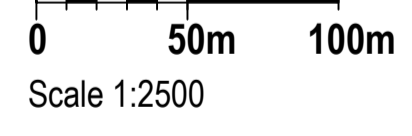
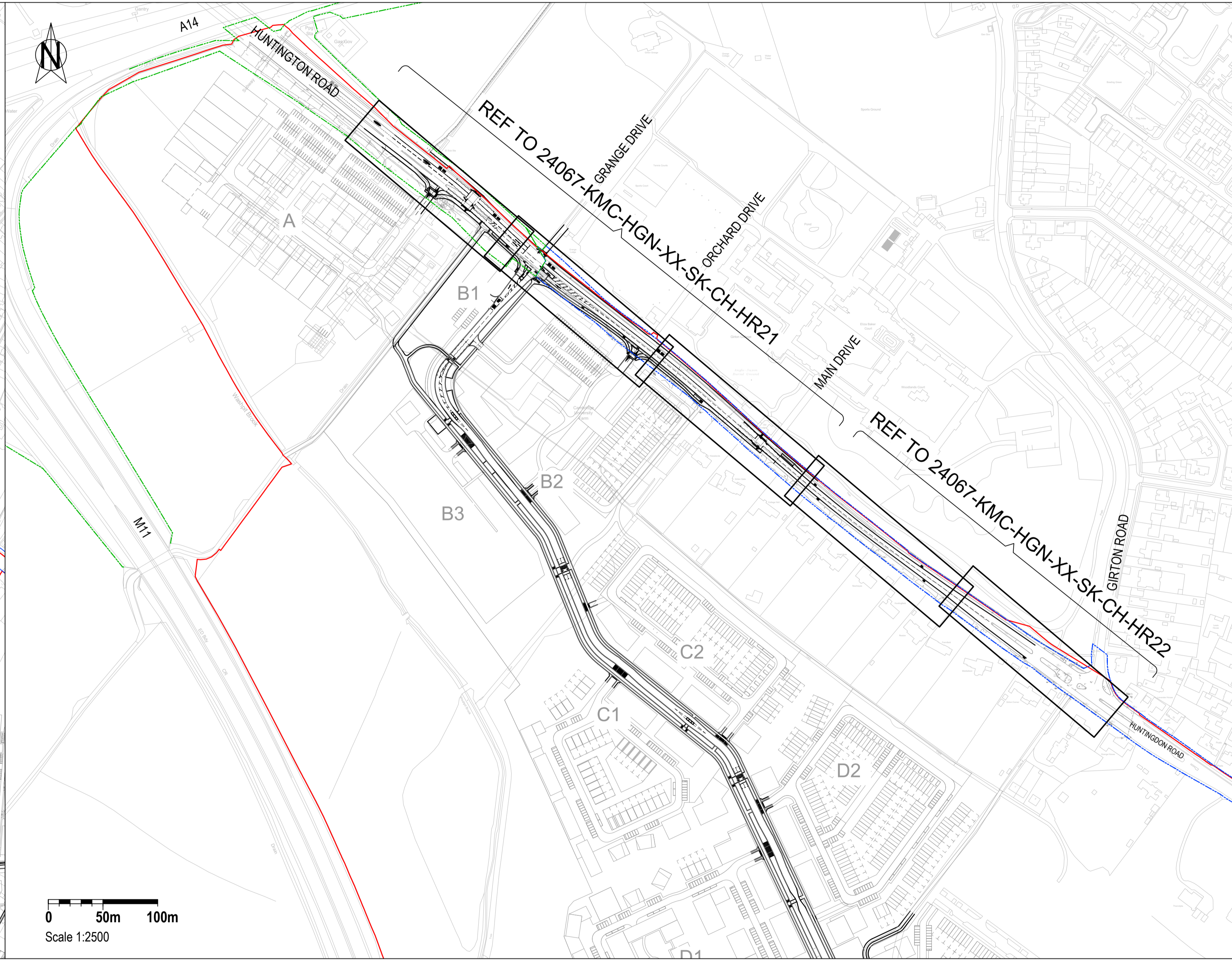

Layout Plan Scale 1:2500

FOR APPROVAL

REV	DATE	DESCRIPTION	DRN	CHKD	APRD	
PL02	01.04.2025	HIGHWAY BOUNDARY ADDED	REVISION	OAS	JP	NP
PL01	17.11.2025	CORRECTED TO PLANNED FOLLOWING CCC COMMENTS	CONCEPT DESIGN	OAS	JP	NP

Issue Status

<input checked="" type="checkbox"/> PLANNING	<input type="checkbox"/> CONSTRUCTION
<input type="checkbox"/> PRELIMINARY	<input type="checkbox"/> AS BUILT
<input type="checkbox"/> TENDER	<input type="checkbox"/> HAS FILE ISSUE

Client
University of Cambridge

Project
North West Cambridge

Drawing Title
Huntingdon Road Overview

Scale @	Drawn	ATD	Chkd	OAS
As shown	Aprd	NP	Date	17.11.2025

Drawing Ref	Rev
24067-KMC-HGN-XX-SK-CH-HR20	PL02

